

# LP65048 - MCS 20 3pt

#	Part #	Qty	Description
1	ST48220	1	Top Channel
2	ST48221	1	Bottom Channel
3	ST61509	2	Cat 1 Pin
4	ST48222	1	Front Sheet 20
5	ST48224	1	Corner Angle LH
6	ST48223	1	Corner Angle RH
7	ST48225	1	Side RH 20
8	ST48226	1	Side LH 20
9	ST48380	1	Rear Top 20
10	ST48228	1	Tailgate Side RH WA
11	ST48229	1	Tailgate Side LH WA
12	ST48231	1	Tailgate 20
13	ST48133	2	Pivot Reinforcement
14	ST48513	1	Pivot Shaft WA
15	ST61011	3	Pivot Tube Saddle
16	ST61010	3	Tube Pivot Cap
17	ST48253	3	Hinge Support
18	ST48249	2	Top Clevis
19	ST48250	1	Bottom Clevis LH
20	ST48251	1	Bottom Clevis RH

#	Part #	Qty	Description
21	ST48254	1	Center Channel
22	ST48257	2	Push Brace
23	ST48258	1	Top Support
24	ST48259	2	Support Angle
25	ST48233	1	Side Brace RH
26	ST48234	1	Side Brace LH
27	ST50224	2	Yoke Clevis End 1/2"
28	ST48268	1	Lid
29	ST48269	1	Top Front
30	ST48275	6	Hinge
31	ST48277	2	Lift Rod MCS 20
32	ST48278	1	Cover Front Support
33	ST48279	2	Cover Side Support
34	ST43399	1	Top Pin, Cat 1
35	ST48281-A	1	Thru Bin Chute
37	ST48282	1	Long Chute
37	ST48283	1	Upper Chute 3pt
38	ST48287	2	Wire Lock Pin ø3/8" x 2"
39	ST65013	41	3/8 x 1 Carriage Bolt
40	ST65012	48	3/8 Flange Nut
41	ST65083	3	1/2" x 3" Flange Bolt
42	ST65037	7	1/2" Flange Nut
43	ST65053	24	1/4 x 3/4 Carriage Bolt
44	ST65073	61	1/4" Flange Nut

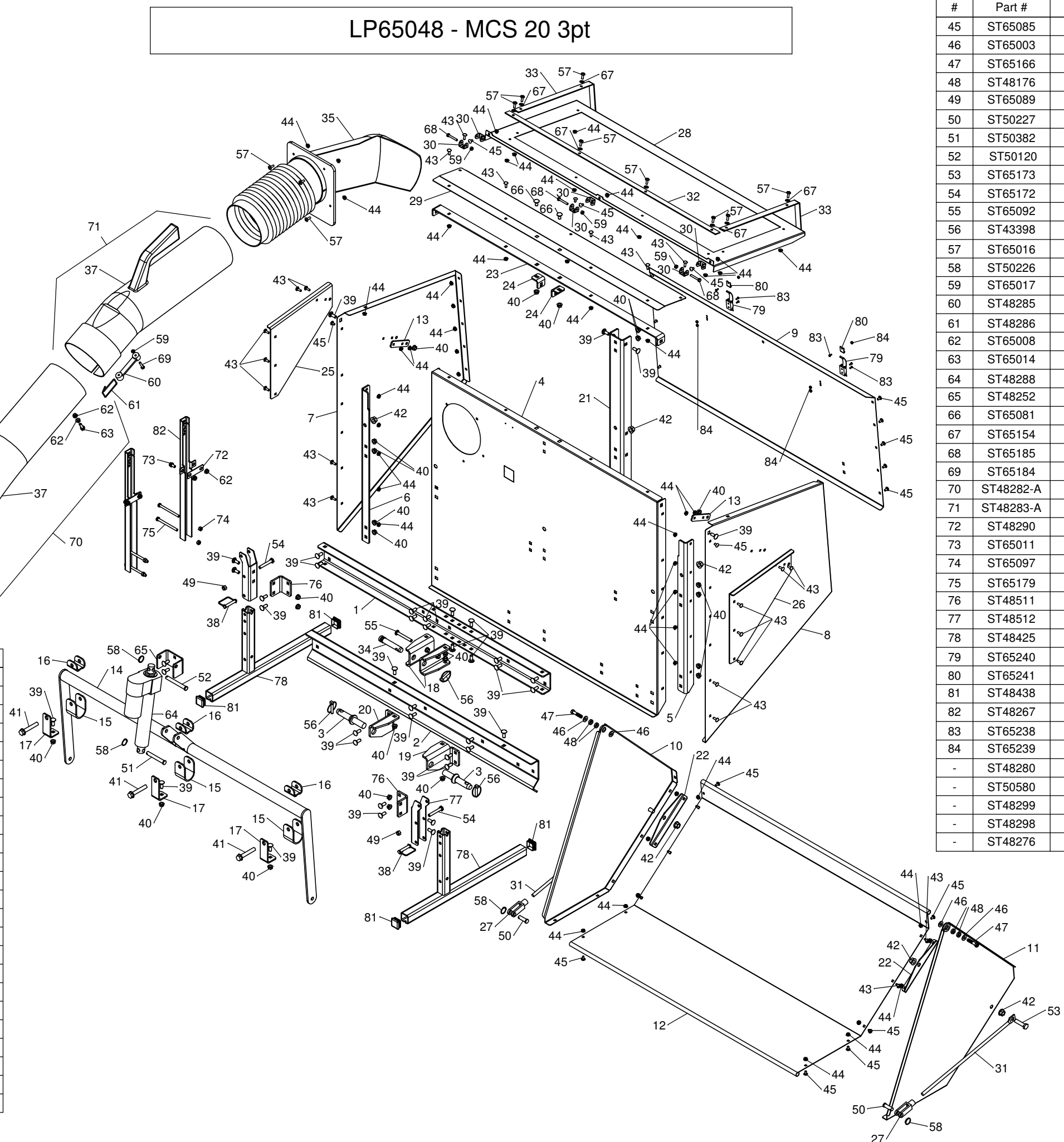

#	Part #	Qty	Description
45	ST65085	24	1/4 x 1/2 C.B. Short Neck
46	ST65003	4	3/8 Flat Washer
47	ST65166	2	3/8" x 1-3/4" Hex Bolt
48	ST48176	4	Plastic Washer
49	ST65089	2	3/8 Nylock / Stover Nut
50	ST50227	2	1/2" x 1-1/2" Clevis Pin
51	ST50382	1	1/2" x 3-1/2" Clevis Pin
52	ST50120	1	1/2"x4" Pin for Actuator
53	ST65173	2	1/2 x 2 Hex Bolt
54	ST65172	2	3/8 x 2-1/2 Hex Bolt
55	ST65092	1	3/8 x 3 Carriage Bolt
56	ST43398	3	Lynch Pin
57	ST65016	12	1/4 x 3/4 Truss Head Bolt
58	ST50226	4	Circle Cotter
59	ST65017	5	1/4 Nylock Nut
60	ST48285	2	Strap
61	ST48286	2	Hook
62	ST65008	6	5/16 Flange Nut
63	ST65014	1	5/16 x 1 Flange Bolt
64	ST48288	1	Actuator 6"
65	ST48252	1	Top Actuator Clevis
66	ST65081	2	3/8 x 3/4 Carriage Bolt
67	ST65154	8	1/4" Washer
68	ST65185	3	1/4"x 1-3/4" Bolt
69	ST65184	2	1/4"x 1-1/4" Bolt
70	ST48282-A	1	Long Chute Assembly
71	ST48283-A	1	Upper Chute Assembly
72	ST48290	2	Backing Plate
73	ST65011	4	5/16 x 5/8 Flange Bolt
74	ST65097	4	5/16" Nylon Lock Nut
75	ST65179	4	5/16 x 4 Hex Bolt
76	ST48511	2	Leg Support Angle
77	ST48512	2	Leg Support Channel
78	ST48425	2	Leg WA
79	ST65240	2	Over Center Latch
80	ST65241	2	Latch Catch
81	ST48438	4	Plastic End Cap 1-1/2"
82	ST48267	2	Bracket, Light Mounting
83	ST65238	6	#6-32 x 3/8" Pan Head
84	ST65239	6	#6-32 Nylon Lock Nut
-	ST48280	1	Fabric Cover
-	ST50580	1	Tractor Wire Harness
-	ST48299	1	Switch Harness w/ Switch
-	ST48298	1	Switch to Actuator Wire
-	ST48276	1	Switch Mounting Bracket